

Curtain installation

Pinch pleat

bargain
blinds and
curtains

Getting started

Be careful not to damage the curtain when opening the packaging. Unpack the curtain and check the following parts are included:

- Curtain/s with hooks attached

Tools required:

- Pencil

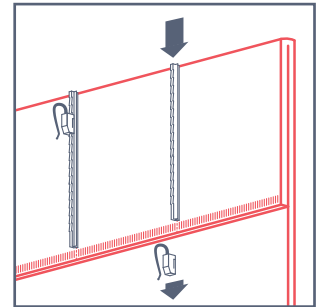
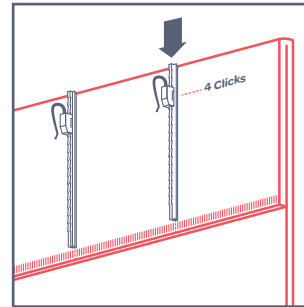
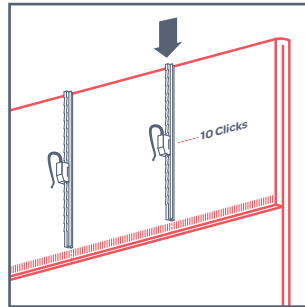

Step 1

Rods and tracks spline setting

These curtains come with adjustable hooks on splines so you can raise and lower the hanging position of your curtain. Start by turning the curtain over so the back is facing you.

For curtains on tracks, set the hooks 45mm or 10 clicks down; and for curtains on rods, set the hooks 15mm or four clicks down. If you click too far, simply push the hook all the way down and off the spline so you can re-thread it back on from the top.

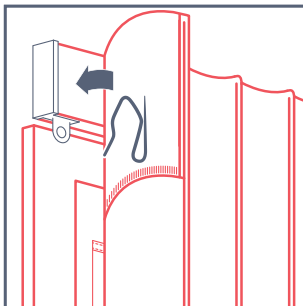

Step 2

The first hook and last hook are metal hooks and must be inserted into the edge of the curtain. Insert the pin hook at the same heading as the plastic hooks to make sure the heading of the curtain is straight.

Lift the curtain off the ground and begin hanging by attaching the first hook into the end of the curtain track. This is the loop that doesn't move and holds your curtains in place.

Tip: We recommend resting the curtain over your shoulder as you do this so it doesn't pull heavily on the track before it is fully installed. You may need someone to help you.

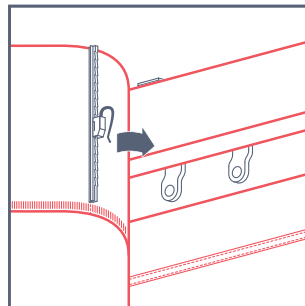

Step 3

Continue hooking the curtain into the glide holes until your curtain is hanging off the track or rod.

For a pair of curtains, repeat steps 1 and 2 from the other side of the track.

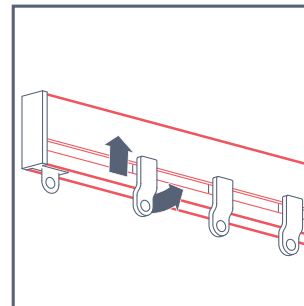

Step 4

To remove any excess glides, grip the bottom of the glide and push it up while also pushing backwards. Reverse this step to add glides where you need them.

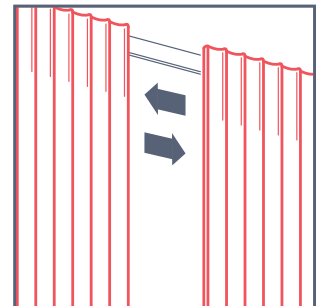

Step 5

Check the fit by pulling the curtains closed to ensure there is enough to overlap at the middle.